

FCI CONFIDENTIAL

PRODUCT NO.	DIM.L	DIM.S
52599-022/022LF	2.2	1.0
52599-043/043LF	4.3	-0.3
52599-050/050LF	5.0	-0.3

NOTES:

- MATERIAL:
  - 1.1 EJECT HEADER ASS'Y  
 PLASTIC HOUSING: LCP UL94V-0 BLACK  
 PIN: COPPER ALLOY  
 PCB: FR4  
 PLASTIC GUIDE: POLYPHTHARAMID UL94V-0 BLACK
  - 1.2 RECEPTACLE  
 PLASTIC: LCP 94V-0 NATURAL  
 PIN: BeCu
- FINISH  
 PIN :  
 UNDER PLATING: 1.27 um MIN. Ni  
 CONTACT AREA: 0.13 um MIN. GOLD OVER  
 0.5 um MIN. Pd-Ni  
 SOLDER TAIL: 2.5 um MIN. Sn-Pb  
 : 2.5 um MIN. PURE Sn (FOR -\*\*\*LF)  
 GROUND SHIELD :  
 UNDER PLATING: 1.27 um MIN. Ni  
 CONTACT SURFACE: 0.2 um GOLD (ONE SIDE ONLY)
- P.C.B. ARE AS APPEARS INSTALLED

4 DIM "X"

4.25±0.1	3.5±0.1	5.0±0.1
OTHERS	36,67	1,17,34,35,51,68

- DO NOT TOUCH AND KEEP CLEAN THE SURFACES OF PCB OF HEADER ASS'Y.
- IF LEAD FREE P/N. THE HOUSING WILL WITHSTAND EXPOSURE TO 260°C PEAK TEMPERATURE FOR 10 SECONDS IN A WAVE SOLDER APPLICATION WITH A 1.00MM MINIMUM THICK CIRCUIT BOARD.
- LEAD FREE PRODUCT MEETS EUROPEAN UNION DIRECTIVES AND OTHER COUNTRY REGULATIONS AS DESCRIBED IN GS-22-008
- IF LEAD FREE P/N. PACKAGING MEETS GS-14-920 SPECIFICATION

ORDERING INFORMATION

NAME	PART NO.	Q'TY
(A) EJECT HEADER ASS'Y	52599-***/***/LF	1
(B) MATING RECEPTACLE	73277-101000/101402LF	1

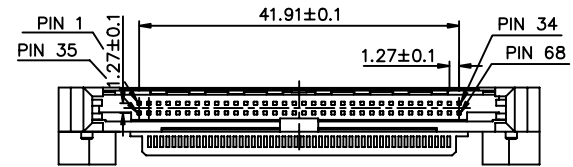
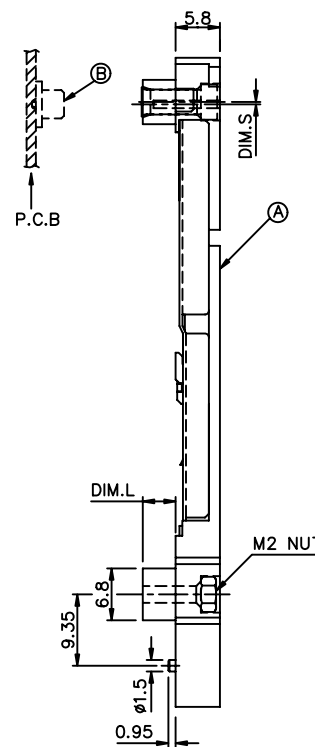
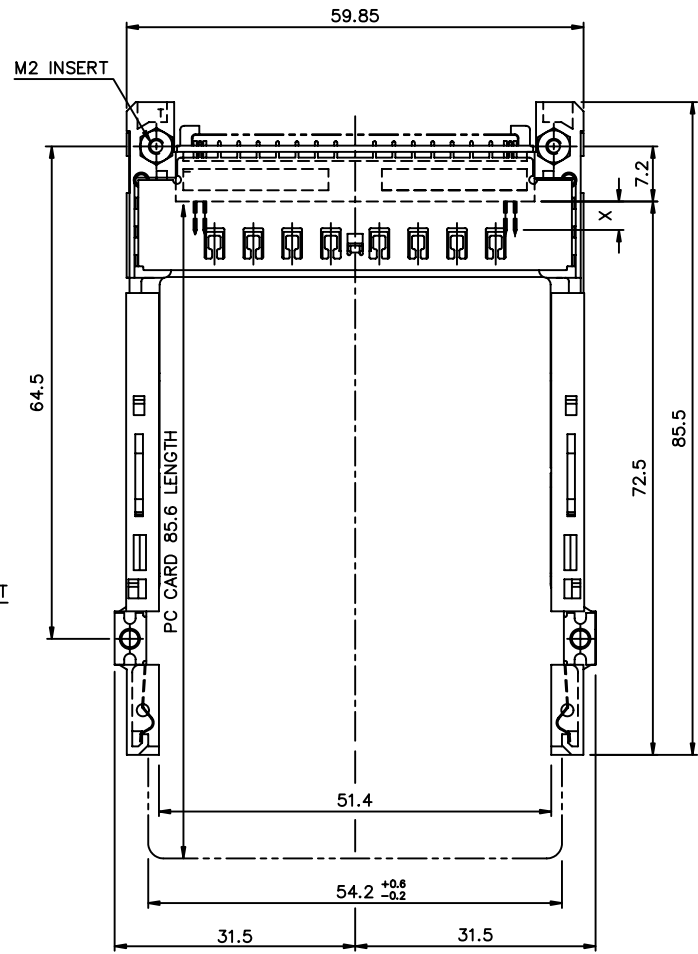

P/N: 52599-\*\*\*/\*\*\*/LF  
 ABOVE P.C.B

mat'l. code		surface		tolerance		projection		product family	
		ISO 1302		ISO 406 ISO 1101				CARDBUS	
ltr	ecm no	dr	date	tolerances unless otherwise specified				title	
A	T00092	WL	04/06/00	angles	linear	± 0.30	MM	CARDBUS NONE PUSH ROD, TYPE 1/2/3	
B	T00270	WL	09/04/00						
C	N05-0135	WB	05/27/05	±2'			scale 1.2:1		
D	N05-0316	MZ	11/18/05	dr	Mike Zhou	08/18/06		dwg no sheet 1of 5 size	
E	N06-0081	MZ	03/28/06	enr	Mike Zhou	08/18/06		52599 A4	
F	N06-0220	MZ	08/18/06	chr	Mike Zhou	08/18/06		type CUSTOMER Drawing	
G	N08-0028	MZ	11/21/06	appd	Qin David	08/18/06			
sheet	revision	G	G	G	G	G			
index	sheet	1	2	3	4	5			

This document is the property of and embodies CONFIDENTIAL and PROPRIETARY information of FCI. No part of the information shown on this document may be used in any way or disclosed to others without the written consent of FCI. Copyright FCI.



FCIconnect.com

FCI CONFIDENTIAL



This document is the property of and embodies CONFIDENTIAL and PROPRIETARY information of FCI. No part of the information shown on this document may be used in any way or disclosed to others without the written consent of FCI. Copyright FCI.

PRODUCT NO.	DIM.L	DIM.S
52599-550	5.0	-0.3
52599-550LF	5.0	-0.3
52599-550MLF	5.0	-0.3

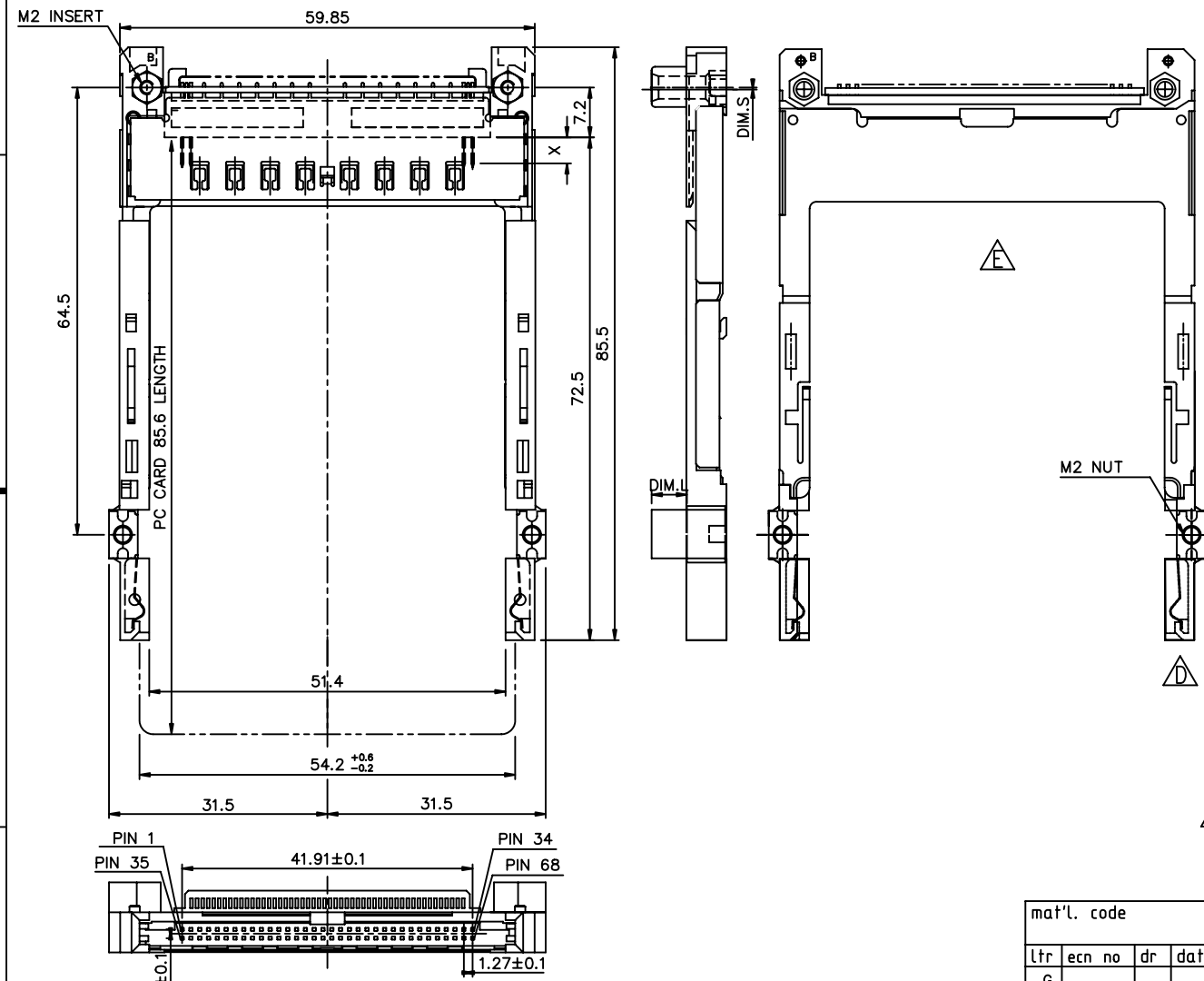

- NOTES:
- MATERIAL:
    - EJECT HEADER ASS'Y  
 PLASTIC HOUSING: LCP UL94V-0 BLACK  
 PIN: COPPER ALLOY  
 PCB: FR4  
 PLASTIC GUIDE: NYLON UL94V-0 BLACK
    - RECEPTACLE  
 PLASTIC: LCP 94V-0 NATURAL  
 PIN: BeCu
  - FINISH  
 PIN :  
 UNDER PLATING: 1.27 um MIN. Ni  
 CONTACT AREA 1: 0.13 um MIN. GOLD OVER  
 0.5 um MIN. Pd-Ni  
 CONTACT AREA 2 : 0.25um MIN.GOLD (FOR\*\*\*\*-MLF)  
 SOLDER TAIL:1) 2.5 um MIN. Sn-Pb  
 :2) 2.5 um MIN. PURE Sn (FOR -\*\*\*LF&-\*\*\*MLF)  
 GROUND SHIELD :  
 UNDER PLATING: 1.27 um MIN. Ni  
 CONTACT SURFACE: 0.2 um GOLD (ONE SIDE ONLY)
  - P.C.B. ARE AS APPEARS INSTALLED
  - DIM "X"
 

4.25±0.1	3.5±0.1	5.0±0.1
OTHERS	36,67	1,17,34,35,51,68
  - DO NOT TOUCH AND KEEP CLEAN THE SURFACES OF PCB OF HEADER ASS'Y.
  - IF LEAD FREE P/N. THE HOUSING WILL WITHSTAND EXPOSURE TO 260°C PEAK TEMPERATURE FOR 10 SECONDS IN A WAVE SOLDER APPLICATION WITH A 1.00MM MINIMUM THICK CIRCUIT BOARD.
  - LEAD FREE PRODUCT MEETS EUROPEAN UNION DIRECTIVES AND OTHER COUNTRY REGULATIONS AS DESCRIBED IN GS-22-008
  - IF LEAD FREE P/N. PACKAGING MEETS GS-14-920 SPECIFICATION

ORDERING INFORMATION

NAME	PART NO.	Q'TY
(A) EJECT HEADER ASS'Y	52599-***/***/**LF	1
(B) MATING RECEPTACLE	73277-101000/101402LF	1

mat'l. code		surface	tolerance	projection	product family
		ISO 1302	ISO 406 ISO 1101		CARDBUS
ltr ecn no dr date		tolerances unless otherwise specified			title
g		angles	linear ± 0.30	MM	CARDBUS NONE PUSH ROD, TYPE 1/2/3
		±2'		scale 1.2:1	
		dr	Mike Zhou 08/18/06		dwg no
		enr	Mike Zhou 08/18/06		sheet 2 of 5
		chr	Mike Zhou 08/18/06		size
		appd	Qin David 08/18/06		A4
					type
					CUSTOMER Drawing
sheet	revision				
index	sheet				

FCI CONFIDENTIAL

PRODUCT NO.
52599-043
52599-050
52599-043LF
52599-050LF

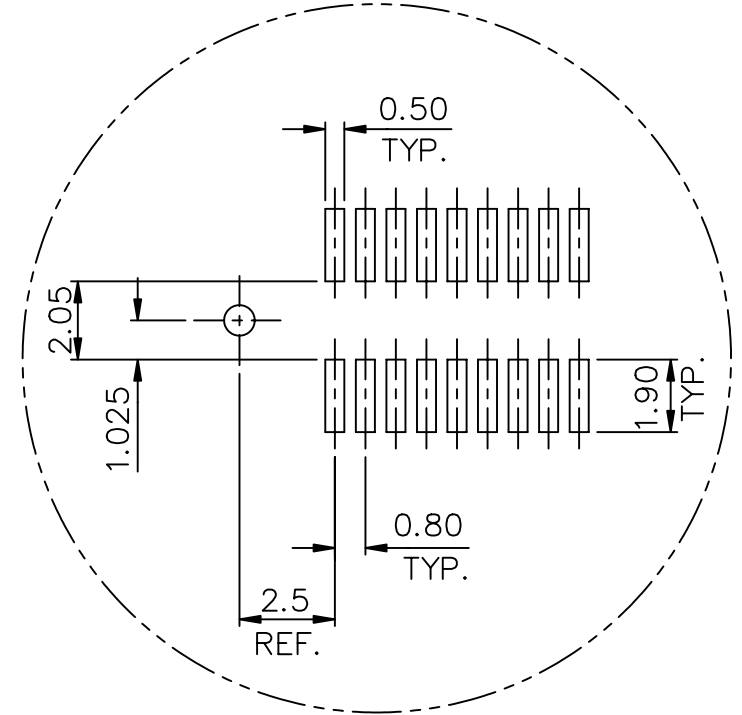
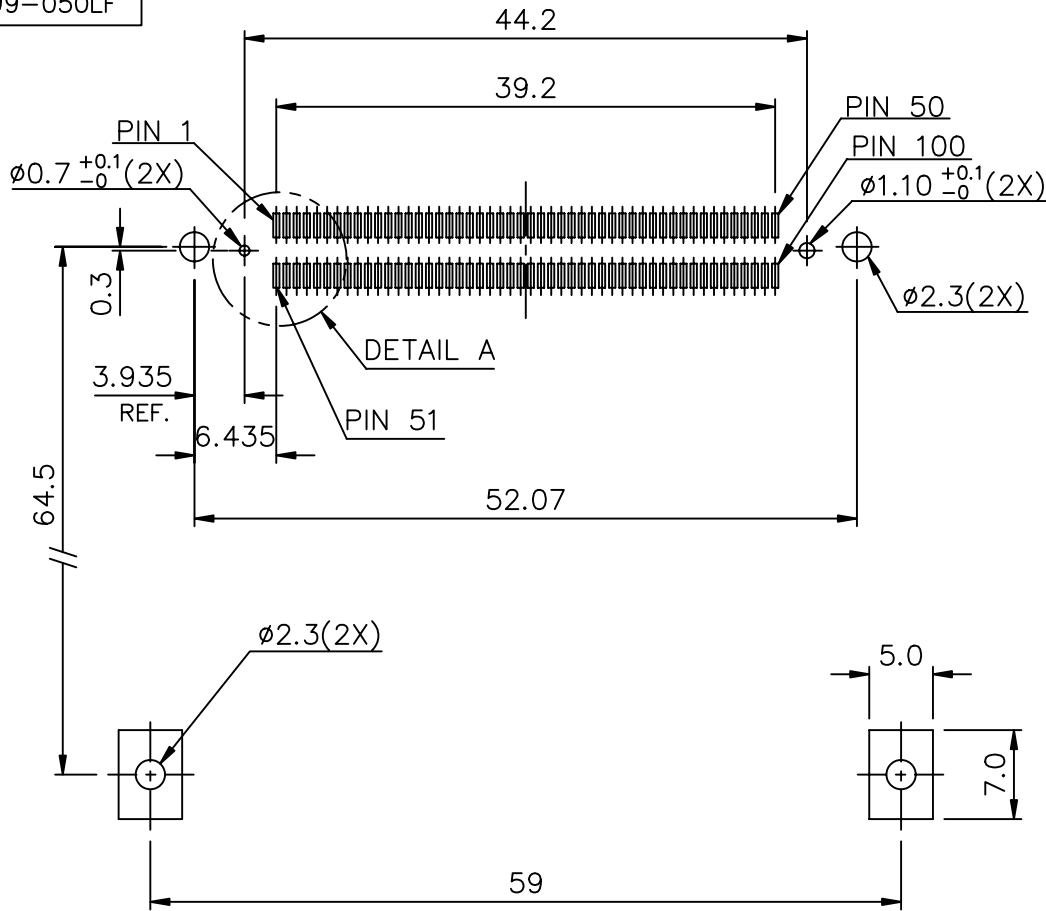

DETAIL A

4 CARD INSERTION DIRECTION

This document is the property of and embodies CONFIDENTIAL and PROPRIETARY information of FCI. No part of the information shown on this document may be used in any way or disclosed to others without the written consent of FCI. Copyright FCI.

mat'l. code		surface		tolerance		projection		product family	
		ISO 1302		ISO 406 ISO 1101				CARDBUS	
ltr		ecm no		dr		date		title	
								CARDBUS NONE PUSH ROD, TYPE 1/2/3	
G				angles		linear			
				±2'		± 0.10		scale 1.5:1	
		dr		Mike Zhou		08/18/06		dwg no	
		enr		Mike Zhou		08/18/06		sheet 3 of 5 size	
		chr		Mike Zhou		08/18/06		52599 A4	
		appd		Qin David		08/18/06		type CUSTOMER Drawing	
sheet		revision							
index		sheet							



PDM: Rev:G

STATUS: Released

Printed: Feb 26, 2008

FCI CONFIDENTIAL

PRODUCT NO.
52599-022
52599-022LF

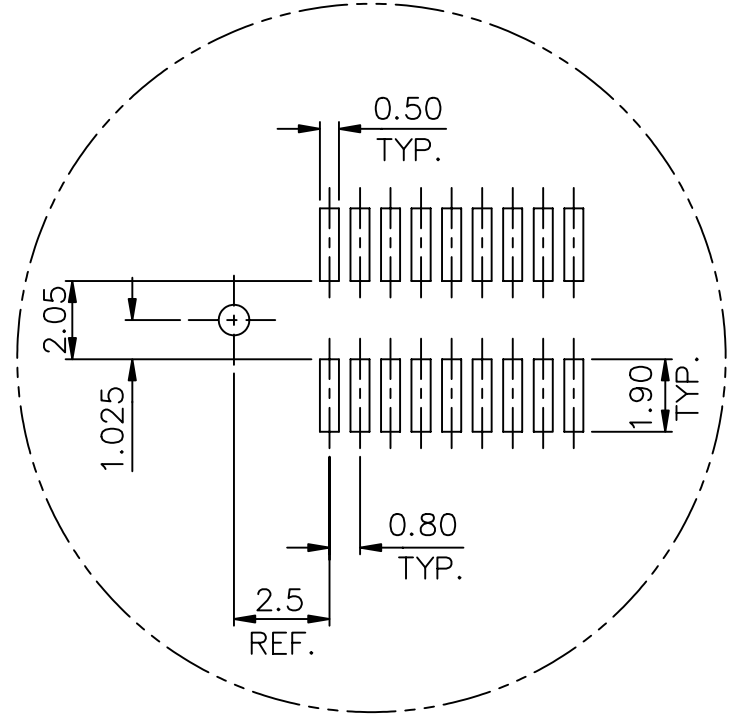
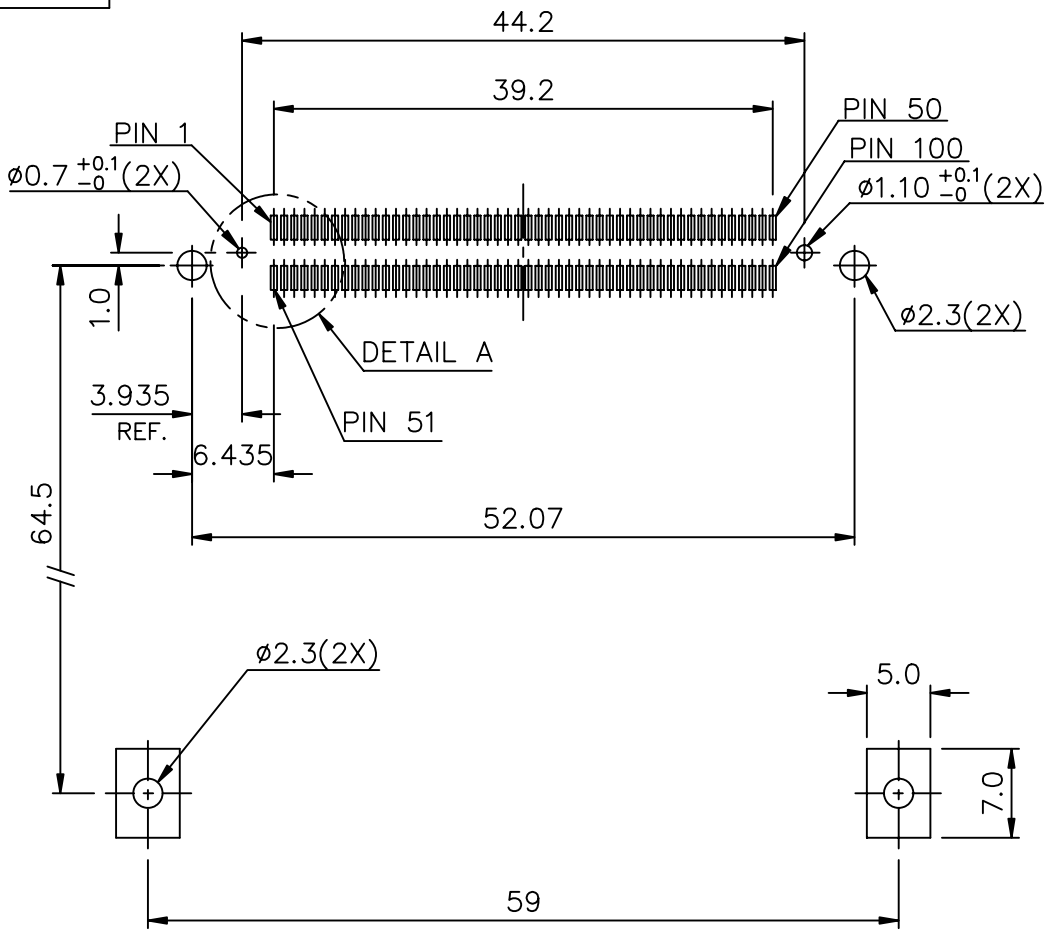

DETAIL A

4 CARD INSERTION DIRECTION

mat'l. code		surface ISO 1302		tolerance ISO 406 ISO 1101		projection 1:1		product family CARDBUS	
ltr		ecm no		dr		date		title	
G								CARDBUS NONE PUSH ROD, TYPE 1/2/3	
		angles		linear		± 0.10		MM	
		± 2'						scale 1.5:1	
		dr		Mike Zhou		08/18/06		dwg no	
		enr		Mike Zhou		08/18/06		sheet 4 of 5 size	
		chr		Mike Zhou		08/18/06		52599 A4	
		appd		Qin David		08/18/06		type CUSTOMER Drawing	
sheet index		revision sheet							



This document is the property of and embodies CONFIDENTIAL and PROPRIETARY information of FCI. No part of the information shown on this document may be used in any way or disclosed to others without the written consent of FCI. Copyright FCI.

FCIconnect.com

FCI CONFIDENTIAL

PRODUCT NO.
52599-550
52599-550LF
52599-550MLF

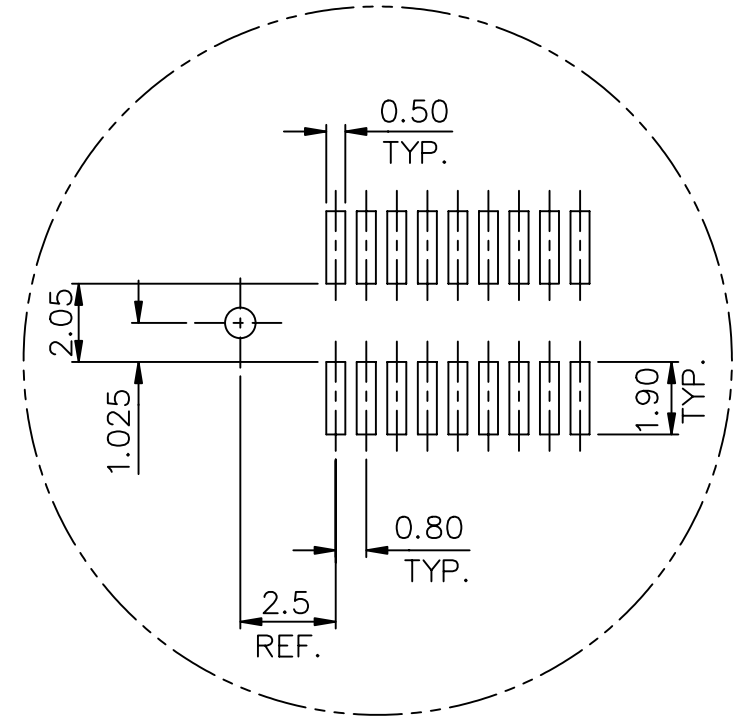
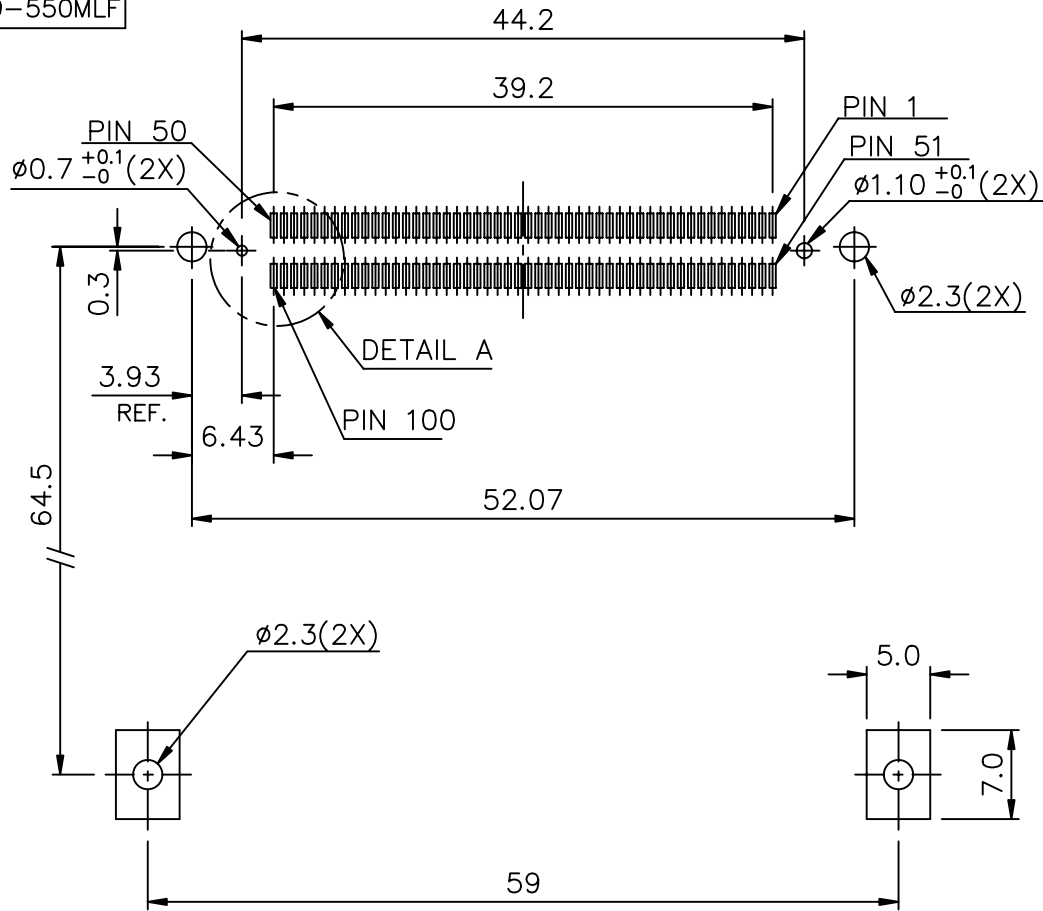

DETAIL A

4 CARD INSERTION DIRECTION

mat'l. code		surface	tolerance	projection	product family		
		ISO 1302	ISO 406 ISO 1101		CARDBUS		
ltr		ecn no	dr	date	title		
G					CARDBUS NONE PUSH ROD, TYPE 1/2/3		
		angles	linear	± 0.10	MM		
		± 2'		scale 1.5:1			
		dr	Mike Zhou	08/18/06			
		enr	Mike Zhou	08/18/06			
		chr	Mike Zhou	08/18/06			
		appd	Qin David	08/18/06			
sheet	revision				dwg no	sheet 5 of 5	size
index	sheet				52599		A4
					type	CUSTOMER	Drawing

PDM: Rev:G

STATUS: Released

Printed: Feb 26, 2008

6

This document is the property of and embodies CONFIDENTIAL and PROPRIETARY information of FCI. No part of the information shown on this document may be used in any way or disclosed to others without the written consent of FCI. Copyright FCI.

FCIconnect.com